



PRODESK

BI-DIRECTIONAL DATA TRANSFER BETWEEN
AUTODESK REVIT AND PROKON
MODELLING | D04

Summary

Prodesk makes BIM possible – it transfers information between **Autodesk® Revit®** and **Sumo**.

What makes this module special?

- Transfer models between **Revit** and **Sumo**
- Bi-directional data transfer
- Custom Families

Detailed Description

The power of BIM lies in the fact that you're not drawing lines in CAD, but rather modelling objects like beams, slabs, and columns. Detailed information about these objects is stored in a model database.

Revit is a multi-discipline BIM software that allows engineers to model buildings with much detail. The information relevant to structural engineers can be transferred to **Sumo** using **Prodesk**. After the detailed analysis and design is complete, the model can be returned to **Revit** to update the existing model.

If PROKON families are used for modelling in **Revit**, beams and columns are transferred directly with their correct section profiles and orientations. However, if default **Revit** families are used, the Revit families can be mapped to the corresponding section in the **PROKON Section Database**.

Prodesk allows you to transfer an entire model or selected portions only.





PRODESK

BI-DIRECTIONAL DATA TRANSFER BETWEEN AUTODESK REVIT AND PROKON MODELLING | D04

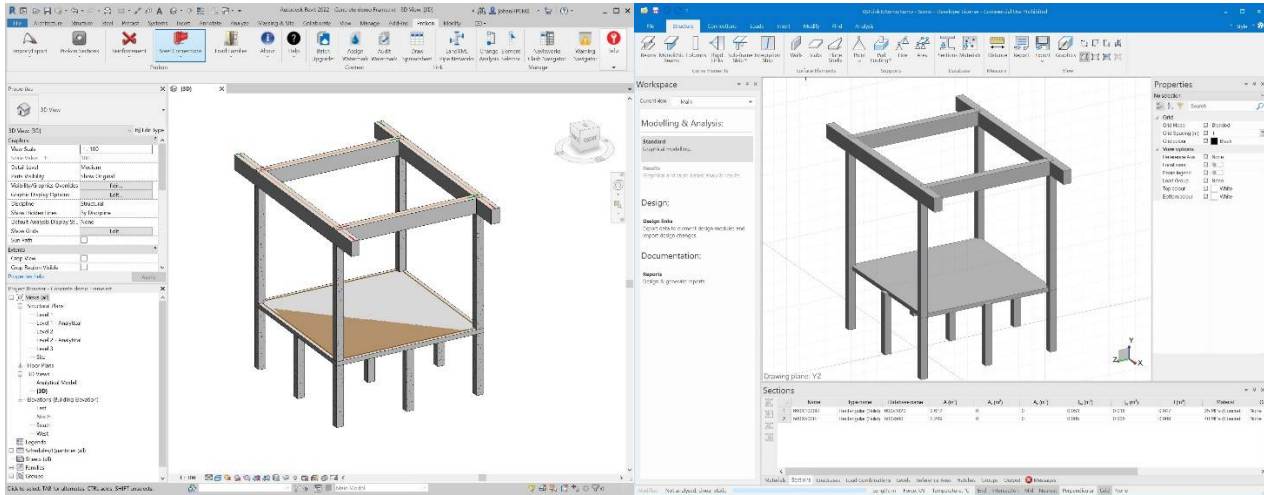

Custom Families

The **PROKON Section Database** is directly available from within **Revit**. Custom **Revit Families** can be generated from the information in the **Section Database**.

Section database

File Steel Concrete Timber Country Help

Circular Sections Rectangular Sections General Sections Custom Sections

Profiles

Designation	A E3	Ix E9	Zx E6	rx (mm)	Iy E9	Zy E6	ry (mm)	Iu E9	Zu E6	ru (mm)	Iv E9	Zv E6	rv (mm)	J E9	Cw E12	ax (mm)	ay (mm)	alfa deg	Non preferred
VOID PRO																			<input type="checkbox"/>
VP 50	28.35	.0185	.2951	25.56	.3373	1.590	109.1	.3373	1.590	109.1	.0185	.2950	25.56	.0311	.1031	62.77	212.1	89.98	<input type="checkbox"/>
VP 115	52.83	.1118	.9975	46.00	1.053	3.507	141.2	1.053	3.506	141.2	.1118	.9970	46.00	.1261	.3706	112.1	300.3	89.95	<input type="checkbox"/>
VP 200	94.70	.5329	3.341	75.01	2.364	6.213	158.0	2.364	6.211	158.0	.5329	3.337	75.01	.6034	1.579	159.5	379.5	0.000	<input type="checkbox"/>
EXAMPLES																			<input type="checkbox"/>
Bridge deck	13220	23640	10730	1337	249E3	29680	4343	249E3	29680	4343	23640	10730	1337	51330	185E6	2203	8400	90.00	<input type="checkbox"/>
Col + RWP	156.0	3.196	14.20	143.1	3.196	14.20	143.1	3.196	14.20	143.1	3.196	14.20	143.1	5.252	1.310	225.0	225.0	90.00	<input type="checkbox"/>

Double click on: designation to enter section.

Bridge deck

Modified Custom concrete sections South Africa